



JOHN SILKIN LANE SE8
2 bedroom apartment

£330,000
SOLD



JOHN SILKIN LANE SE8

Offered to the market chain free is this spacious, two bedroom apartment situated within a popular Development, John Silkin Lane, Deptford SE8. The capacious accommodation comprises a large reception room, separate fitted kitchen, a large double bedroom, one single bedroom and a three piece bathroom suite. Further benefits include off street parking and double glazing. With the fantastic transport links that Surrey Quays has to offer, this apartment is perfect for the commuter. John Silkin Lane is also favourably located for a vast array of shops and eateries, amongst other amenities, within easy reach.

Borough: Lewisham* Council Tax: C* EPC: TBA Lease Term: 160* Service Charge: £1,200* Ground Rent: £100*

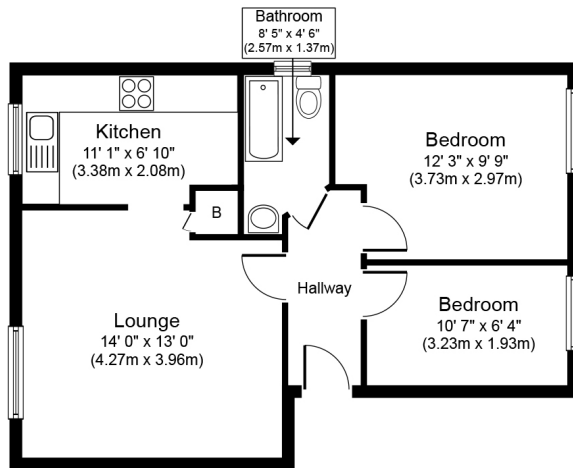

Approximate Floor Area
502 sq. ft.
(46.70 sq. m.)



Rotherhithe & Bermondsey Office
146 Lower Road, London SE16 2UG

t: 020 7237 6767 e: rotherhithe@alexneil.com

Disclaimer: Property descriptions are subjective and used in good faith as an opinion rather than statements of fact. The owner provided information relating to title, tenure, service charges and ground rent information. Therefore, please make specific enquiries to ensure that our descriptions match your expectations of the property. Floor plan measurements are approximate and for illustrative purposes only. Furthermore, we have not tested any services, systems or appliances at this property. And we strongly recommend that you verify all the provided information on inspection and that your surveyor and conveyancer further confirm details. Also, market conditions and property values regularly fluctuate. And showcased sold properties demonstrate our previous successes rather than indicate live property values. *As advised by the owner. **Property sold subject to contract.

ALEX NEIL

ESTATE AGENTS SINCE 1984