



BURNABY COURT SE16  
**1 bedroom apartment**

**£325,000**  
SOLD





# BURNABY COURT SE16

Priced to sell and offered to the market chain free is this one-bedroom apartment situated in a modern development that is ideally placed for core transport links to the City, Canary Wharf and beyond. Burnaby Court is presented in excellent condition throughout and includes a spacious lounge, semi open plan kitchen, a large bedroom and a modern bathroom. Benefits include parking, storage and a gated communal garden. Ideally situated within 0.1 miles of Bermondsey Station and the plethora of local amenities and eateries that Bermondsey has to offer. Early viewings are highly recommended.

Borough: Southwark\* Council Tax: C\* EPC: C Lease Term: 96\* Service Charge: £1,876\* Ground Rent: £150\*

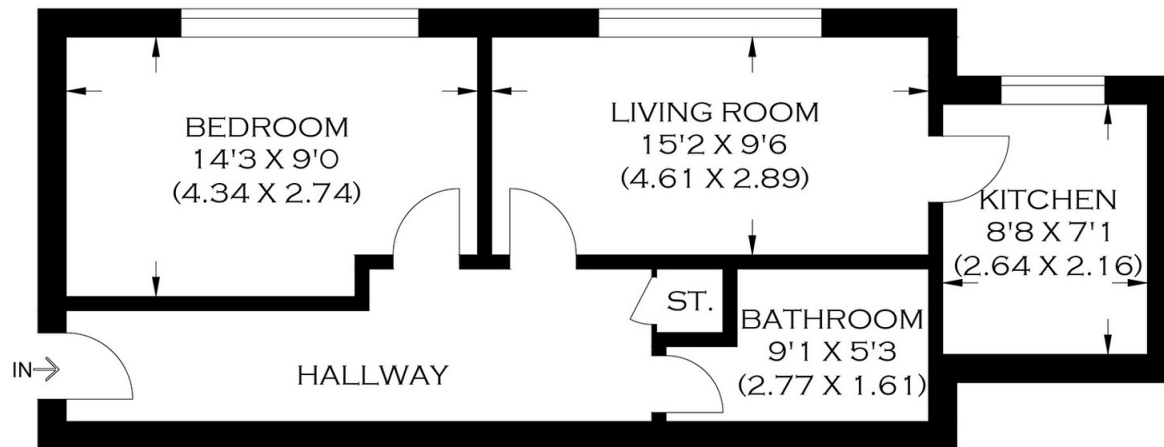

APPROXIMATE GROSS INTERNAL AREA  
43.04 SQ M / 463.27 SQ FT

**Rotherhithe & Bermondsey Office**  
146 Lower Road, London SE16 2UG

t: 020 7237 6767 e: rotherhithe@alexneil.com

Disclaimer: Property descriptions are subjective and used in good faith as an opinion rather than statements of fact. The owner provided information relating to title, tenure, service charges and ground rent information. Therefore, please make specific enquiries to ensure that our descriptions match your expectations of the property. Floor plan measurements are approximate and for illustrative purposes only. Furthermore, we have not tested any services, systems or appliances at this property. And we strongly recommend that you verify all the provided information on inspection and that your surveyor and conveyancer further confirm details. Also, market conditions and property values regularly fluctuate. And showcased sold properties demonstrate our previous successes rather than indicate live property values. \*As advised by the owner. \*\*Property sold subject to contract.



Like this property but need to  
**SELL** your current home?

Call us today on **020 7237 6767**  
for your complimentary appraisal.

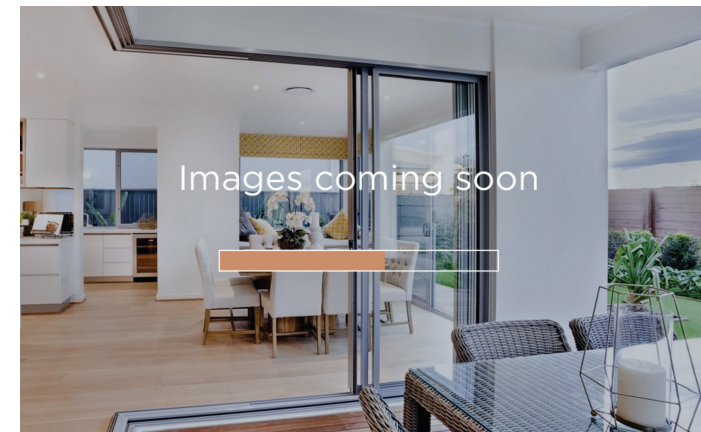

**ALEX NEIL**

ESTATE AGENTS SINCE 1984