



ADAMS GARDENS ESTATE SE16
2 bedroom duplex apartment

£325,000
SOLD



ADAMS GARDENS ESTATE SE16

A split level two bedroom apartment, set in the ideally located Adams Gardens Estate. The property comprises of a lounge, separate fitted kitchen, two bedrooms and a family bathroom. Located adjacent to Rotherhithe Over-ground station, offering excellent transport links to Central London and the City. Benefits include storage space, off street parking and secure entry.

Borough: Southwark* Council Tax: C* EPC: D Lease Term: 96 years* Service Charge: £1,140* Ground Rent: £10*
Nearest Station: Rotherhithe (0.07 miles) Material Information: www.alexneil.com/material-information

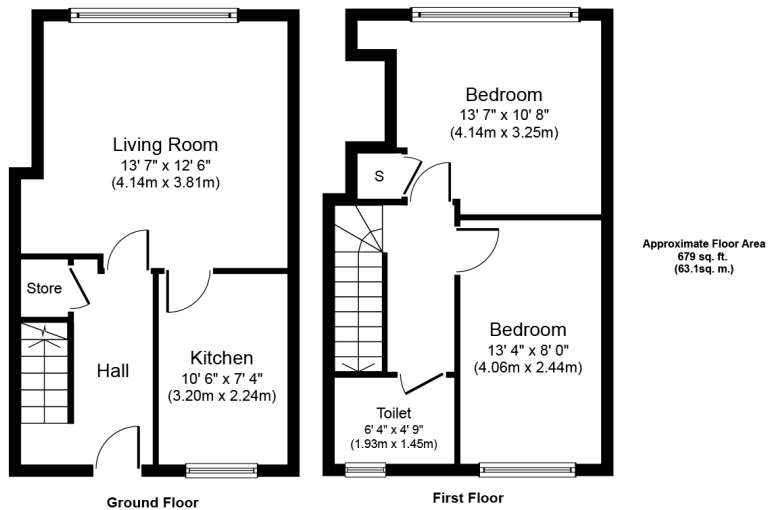

Rotherhithe & Bermondsey Office
146 Lower Road, London SE16 2UG

t: 020 7237 6767 e: rotherhithe@alexneil.com

Disclaimer: Property descriptions are subjective and used in good faith as an opinion rather than statements of fact. The owner provided information relating to title, tenure, service charges and ground rent information. Therefore, please make specific enquiries to ensure that our descriptions match your expectations of the property. Floor plan measurements are approximate and for illustrative purposes only. Furthermore, we have not tested any services, systems or appliances at this property. And we strongly recommend that you verify all the provided information on inspection and that your surveyor and conveyancer further confirm details. Also, market conditions and property values regularly fluctuate. And showcased sold properties demonstrate our previous successes rather than indicate live property values. *As advised by the owner. **Property sold subject to contract.

ALEX NEIL

ESTATE AGENTS SINCE 1984