



BATH HOUSE E2
1 bedroom apartment

£365,000
SOLD



BATH HOUSE E2

A truly unique one bedroom apartment set within the sought-after and prestigious Bath House Development which is an historical Grade II Listed Victorian Bath House. The property is offered chain free and boasts an open plan reception room with a fitted kitchen, a large and airy bedroom and a modern three piece bathroom. Featuring a parking space, high ceilings, sash windows, a communal garden, and copious period character throughout. Ideally set in the famous Bethnal Green area that offers fantastic transport links and an abundance of local amenities. Viewing highly recommended.

Borough: Tower Hamlets* Council Tax: D* EPC: D Lease Term: 106* Service Charge: £1,077* Ground Rent: £150*

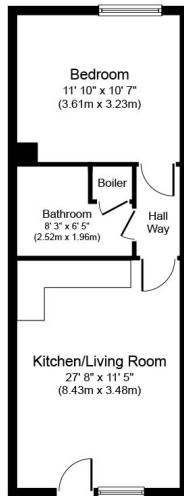

Approximate Floor Area
398 sq. ft.
(37.0 sq. m.)



Canary Wharf & Docklands Office
2 Westferry Road, Canary Wharf, London E14 8JT

t: 020 7537 9859 e: canarywharf@alexneil.com

Disclaimer: Property descriptions are subjective and used in good faith as an opinion rather than statements of fact. The owner provided information relating to title, tenure, service charges and ground rent information. Therefore, please make specific enquiries to ensure that our descriptions match your expectations of the property. Floor plan measurements are approximate and for illustrative purposes only. Furthermore, we have not tested any services, systems or appliances at this property. And we strongly recommend that you verify all the provided information on inspection and that your surveyor and conveyancer further confirm details. Also, market conditions and property values regularly fluctuate. And showcased sold properties demonstrate our previous successes rather than indicate live property values. *As advised by the owner. **Property sold subject to contract.

ALEX NEIL

ESTATE AGENTS SINCE 1984