



CANUTE GARDENS SE16  
**3 bedroom duplex apartment**

**£390,000**  
SOLD





# CANUTE GARDENS SE16

LOCATION LOCATION LOCATION! A three bedroom split level maisonette situated within easy reach of Surrey Quays and Canada water Stations allowing superb transport links. The property offers ample living space and internally comprises a substantially sized reception reception room, separate fitted kitchen, three double bedrooms and a family bathroom. Benefits include double glazing, central heating, residents parking and storage space. Canute Gardens is well placed for the wonderful green space of Southwark Park and is within the catchment of several highly regarded schools.

Borough: Southwark\* Council Tax: C\* EPC: E Lease Term: 109 years\* Service Charge: £1,200\* Ground Rent: £50\*

Nearest Station: Surrey Quays (0.09 miles) Material Information: [www.alexneil.com/material-information](http://www.alexneil.com/material-information)

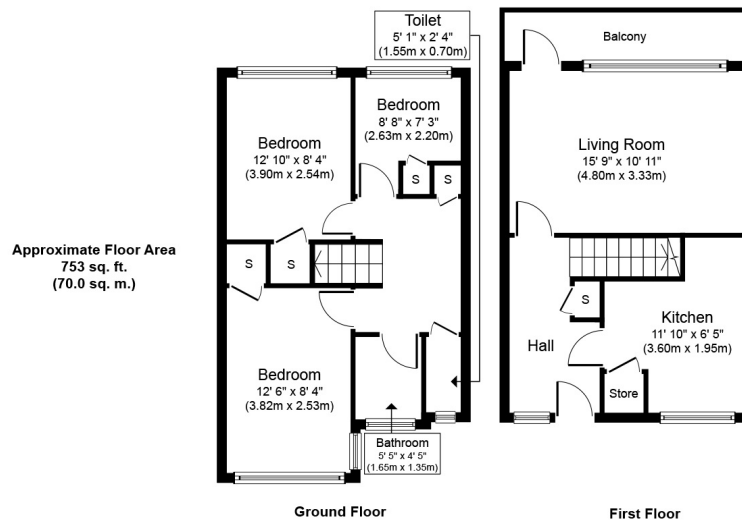

**Rotherhithe & Bermondsey Office**  
146 Lower Road, London SE16 2UG

t: 020 7237 6767 e: [rotherhithe@alexneil.com](mailto:rotherhithe@alexneil.com)

Disclaimer: Property descriptions are subjective and used in good faith as an opinion rather than statements of fact. The owner provided information relating to title, tenure, service charges and ground rent information. Therefore, please make specific enquiries to ensure that our descriptions match your expectations of the property. Floor plan measurements are approximate and for illustrative purposes only. Furthermore, we have not tested any services, systems or appliances at this property. And we strongly recommend that you verify all the provided information on inspection and that your surveyor and conveyancer further confirm details. Also, market conditions and property values regularly fluctuate. And showcased sold properties demonstrate our previous successes rather than indicate live property values. \*As advised by the owner. \*\*Property sold subject to contract.

# ALEX NEIL

ESTATE AGENTS SINCE 1984